

# Expand MediaScreen 2 Outdoor

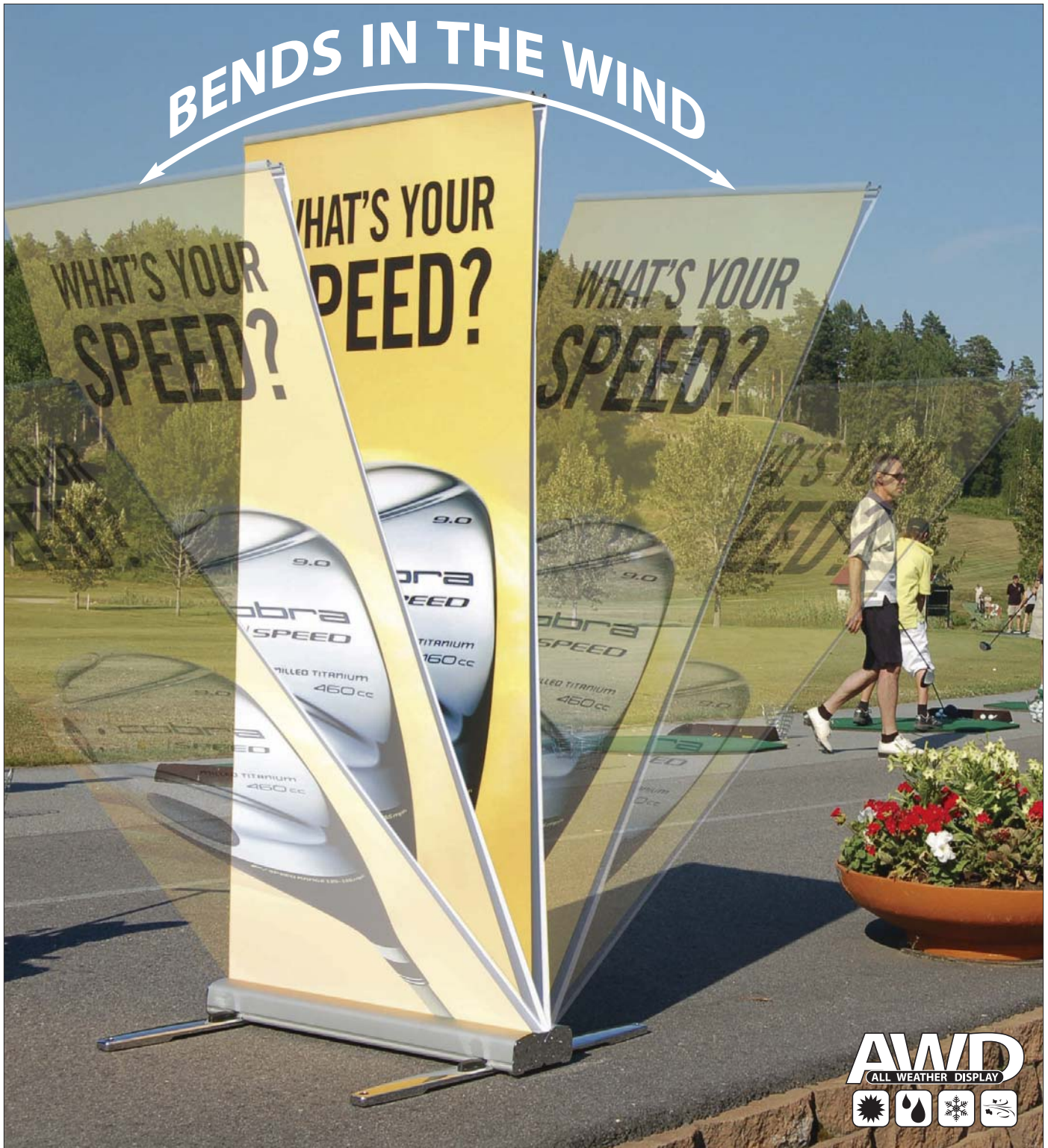

The world's first, outdoor, portable, retractable display

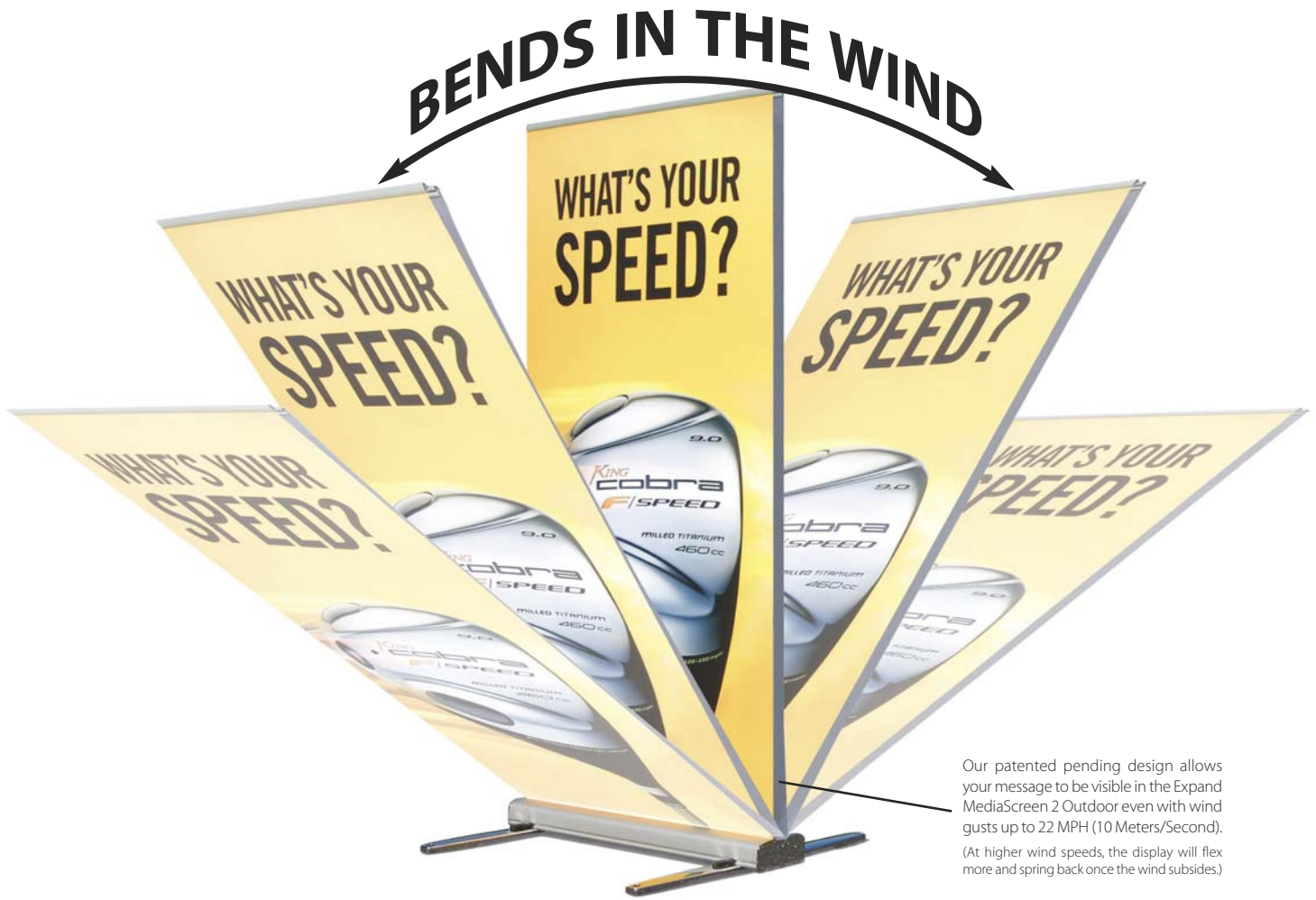

Our patented pending design allows your message to be visible in the Expand MediaScreen 2 Outdoor even with wind gusts up to 22 MPH (10 Meters/Second). (At higher wind speeds, the display will flex more and spring back once the wind subsides.)



**At the Left:** The weighted, support feet mount easily to the base, providing stability on flat surfaces such as snow, grass, sand, pavement and concrete.



**At the Right:** Optional stakes are available for additional stabilization on soft surfaces such as snow and grass.

### Expand MediaScreen 2 Outdoor

The Expand MediaScreen 2 Outdoor is a very functional outdoor product with attractive design. This is the first fully portable double-sided retractable display that can be used outdoors. The product is easy to carry and it only takes a minute to set up. The Expand MediaScreen 2 Outdoor endures wind, rain and snow, and is of very high quality to resist corrosion, UV-radiation and wear and tear by weather and wind. The Expand MediaScreen 2 Outdoor can be used on most surfaces, such as snow, sand, grass

and asphalt and is an effective means to get close to your target audience – everywhere and in all environments. The extra-strong, clamping profile holds most materials and attaches to the top of the pole and does not allow the pole to protrude above the image. The spring-loaded pole is designed to flex in the wind. Thanks to the extended stabilization feet and the spring-loaded pole, the graphic is allowed to flex while the base remains stable. With a 22 MPH wind, the graphic will flex to approximately a 60 degree angle.

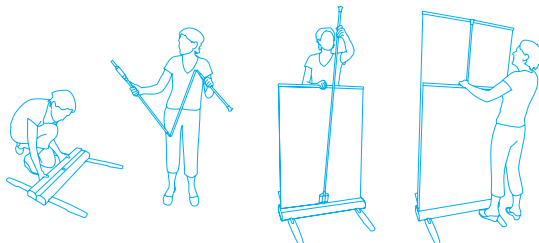

Width: 33 7/16" (85 cm). Height: 70 7/8" (180 cm).